

Swing Check Valve, Metal Seated

PN16 Temp -20°C to 70°C DN350 to DN800

Tel. +44 (0)1788 229 937
sales@utilitiesvalves.com
www.utilitiesvalves.com



Technical Information

- Design in accordance to BS EN 12334 (BS 5163) 14
- Flange and drilling in accordance EN1092-2, PN16
- Face to face in accordance to EN558 series 10
- Pressure test in accordance to EN12266-1
- Use for water, waste water and neutral liquids to max 70°C
- Epoxy coated internally and externally min. thickness 250 µm

Material Options

No.	Name	Material
1	Body	Ductile Iron EN-GJS-500-7
2	Disc	Ductile Iron EN-GJS-500-7
3	Rocker	Ductile Iron EN-GJS-500-7
4	Disc Sealing Ring	Gunmetal - LG2
5	Body Sealing Ring	Gunmetal - LG2
6	Shaft	Stainless Steel 1.4021
7	Lever & Weight	Ductile Iron EN-GJS-500-7
8	Cover	Ductile Iron EN-GJS-500-7
9	O-Ring	EPDM WRAS approved
10	Bushes	DU Bushes
11	Top Cover Plate	Ductile Iron EN-GJS-500-7
12	Gasket	EPDM WRAS approved
13	Pin Shaft	Stainless Steel 1.4021
14	Guard	Steel FBE Coated

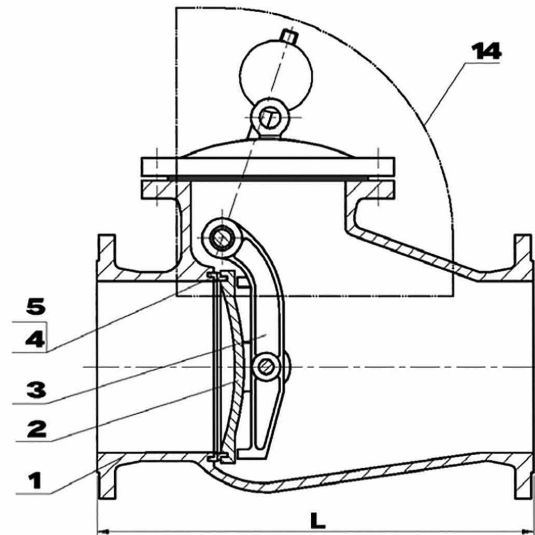
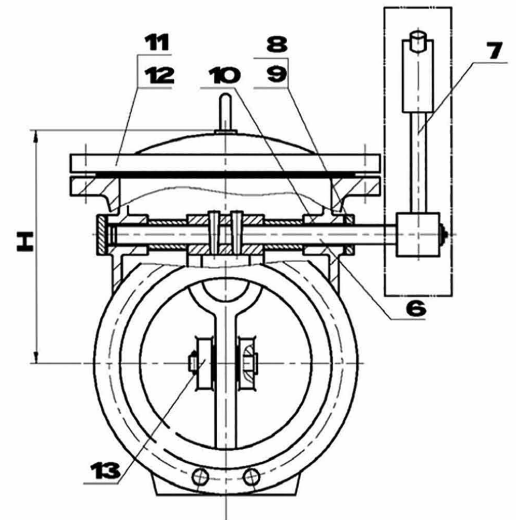

Dimensions table

DN	H (mm)	L (mm)
350	430	787
400	472	914
450	525	965
500	561	978
600	617	1295
700	745	1448
800	811	1676

Utilities Valves Ltd. reserves the right to change product design and specification without notice.

WRAS Approved Materials